



# MICROWAVE BLIND SPOT SENSOR SYSTEM

## RVS-119

## MANUAL

### Microwave Blind Spot Sensor System Function

Blind spots exist around every vehicle.

The RVS-BES02-MV gives the driver visual and aural alerts when an object enters the blind spots to the side and behind their vehicle.

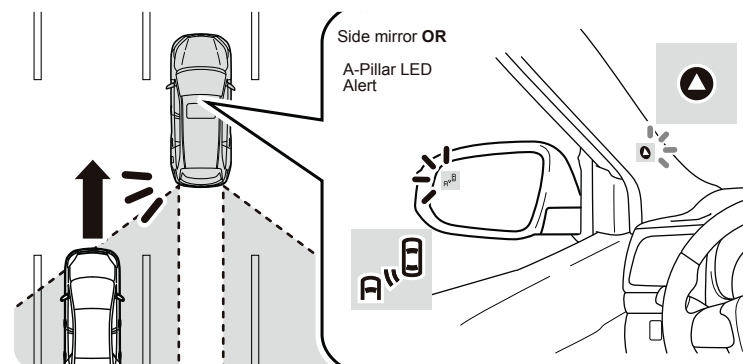

#### NOTICE:

\*The Microwave Blind Spot System is intended as a driving aid. In addition to using the device, visual confirmation from the driver is necessary to safely change lanes. The system may not function properly in severe weather. Turning on the emergency blinker will turn the system off.

An LED flashing alert and aural buzzer warning will occur when the turn signal is on and there is a vehicle in the blind spot. The warning will continue until the detected vehicle leaves the blind spot area. The OBD plugin model will only operate at speeds above 4 MPH.

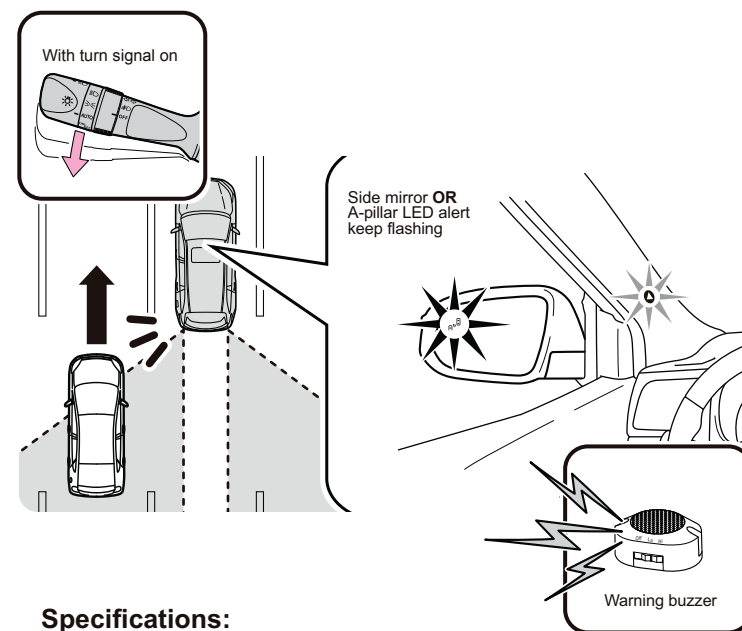

#### Specifications:

Working Voltage: 12V  
Operation Current: 200mA  
Power Consumption: 2.4W  
Working Temperature: -40°C ~ +85°C  
Sensor Detecting Range: 15m  
Sensor Detecting Angle: 72°

### Wiring

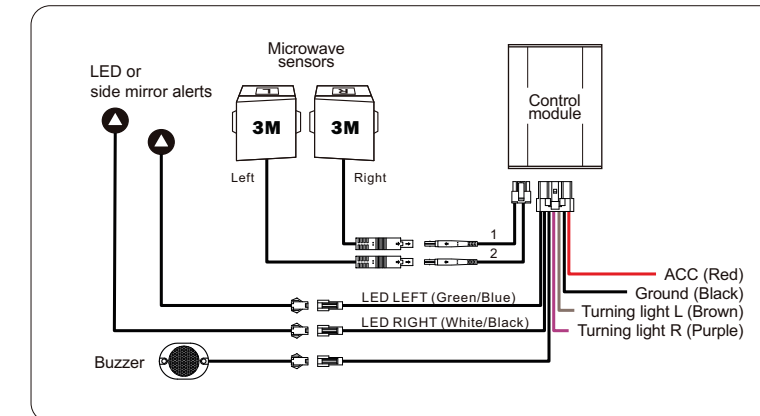

### OBD Plugin Wiring

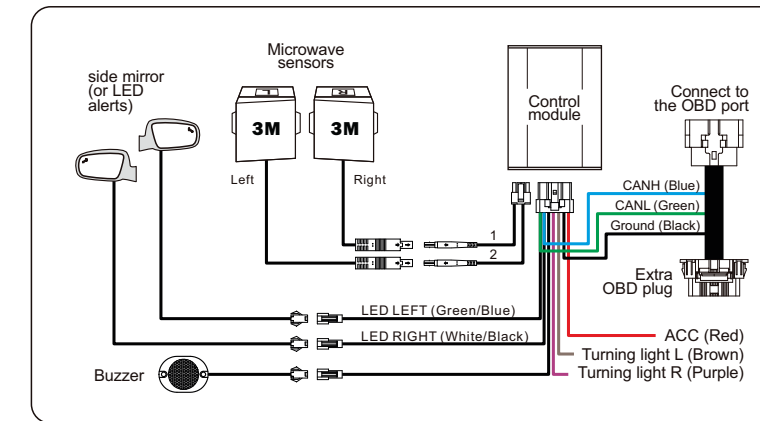

#### NOTICE:

\***Side mirror add-on** and **OBD model** are only compatible with specific vehicle models. Please check availability with retailer.  
\*Only one type of display alert (LED or side mirror) are included in each model of kit.

## Wiring diagram for LEFT hand drive vehicle

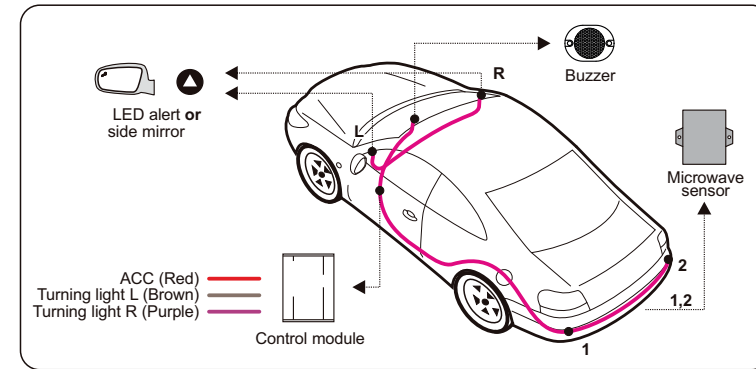

## Wiring diagram for RIGHT hand drive vehicle

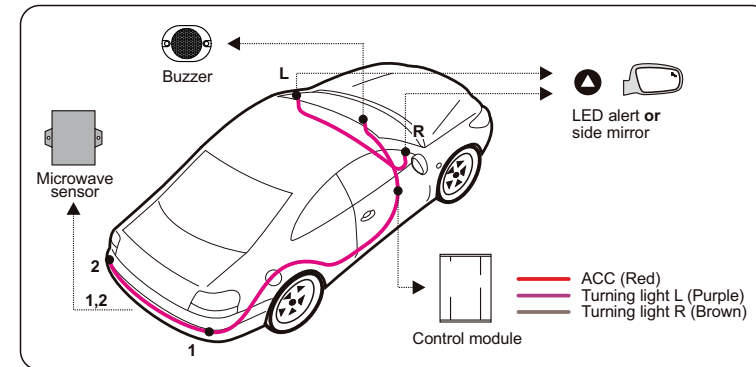

### NOTICE:

- \* **Turning light wire L/R** installation in LEFT hand drive vehicle is opposite to that in a RIGHT hand drive vehicle.
- \* Sensors cannot be installed with the metal bumper. Make sure **no metals or wires** cover the front area of microwave sensors.

## Microwave Sensor Installation

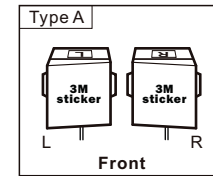

- 1) Take the rear bumper off and 2) locate a spot in the corner of the **INNER SIDE OF THE REAR BUMPER** (close to the rear) to attach the microwave sensor. The installation should be at least 45 cm from the ground.

- 3) Use adhesive to fasten the sensor spacer to rear bumper. Avoid dripping the adhesive on the sensors.

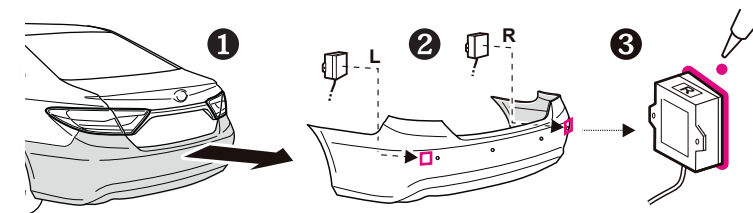

\*If reverse sensors are already installed, place microwave sensors beside them. Reverse sensors should face outmost.

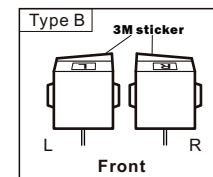

- 1) Take the rear bumper off and 2) locate a spot in the corner of the **CAR FRAME** to attach the microwave sensor. The installation should be at least 45 cm from the ground.

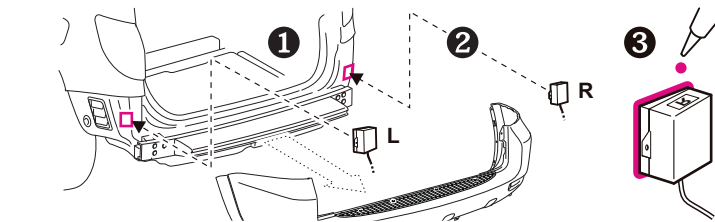

\*Disassembling sensors will cause damage and void the warranty.

## Microwave Sensor Detection Area

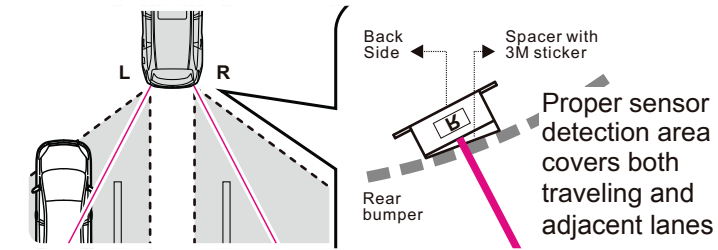

## A-pillar LED Alert Installation

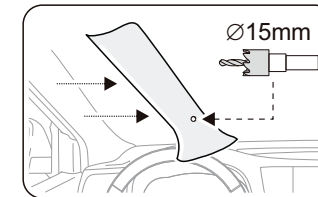

Take the A-pillar trim cover off and use the included 15mm saw to drill a mounting hole close to the sightline of the side mirror.

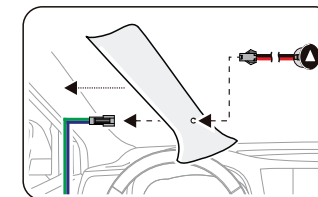

Thread the LED alert terminal and wire through the hole and connect the alert cable. Snap the LED alert onto mounting hole. Reinstall A-pillar cover.

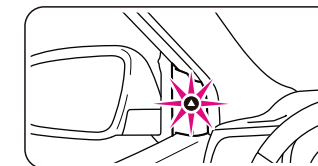

The LED alert can also be installed on triangular panels of front door if sufficient space is available.

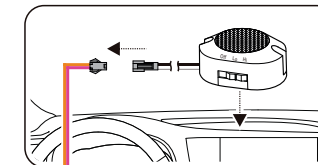

Place the buzzer on the dash and fasten with included double-sided sticker. Connect wires to control module.

## Mirror Installation

- 1) Take the side mirror off, remove the original mirror and disassemble the housing. 2) Thread the mirror cable through the holder out back to the vehicle.
- 3) Replace the original mirror with the mirror and remount the housing. Install the exterior mirror back to the car front door. Using the included adapter cable connect the mirror to the main wire harness.

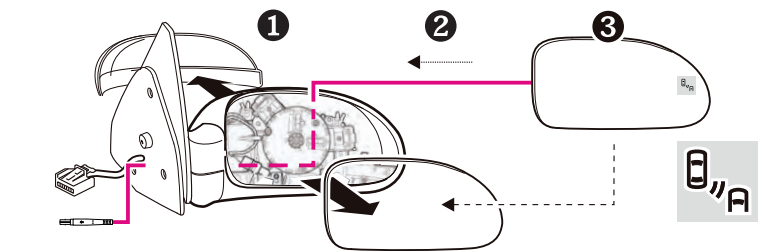

\*Adapter cable only included in side mirror kit.

## Finishing installation

